

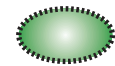

Summary: Areas that Work Well & Areas that Need Fixing

 Areas that work well

Notes:

- A. Pedestrian pathway network is very effective.
- B. Open space is well defined by the landscape features, mature trees and historic buildings.
- C. Open space (with mature trees and historic landscape features) and associated historic buildings are very attractive. Appealing pedestrian scale.
- D. 13th Avenue gateway is welcoming and creates a cohesive campus design. Integrated seating ledges are well used.
- E. Knight Library west gate creates an attractive entrance and provides much-needed covered bike parking.
- F. Mature tree canopy creates an attractive walkway.

 Areas that need fixing

Notes:

- 1. Lack of connection to the main campus. Unattractive parking area (potential to increase canopy coverage).
- 2. Building's large scale and architectural style is out of character with the area. Unwelcoming and confusing entrances.
- 3. Well-used campus entry needs improvement.
- 4. Open space character is dominated by a road that is used as a short cut/parking for autos. Problem is worsened by difficult service access and loss of big canopy trees.
- 5. Service area, auto parking (and meters) dominate building entrance.
- 6. Predominantly vacant historic building is in the heart of campus (within the 7-minute walking circles).
- 7. Uninviting, barren seating area and building facades.
- 8. Security and safety edge issues.

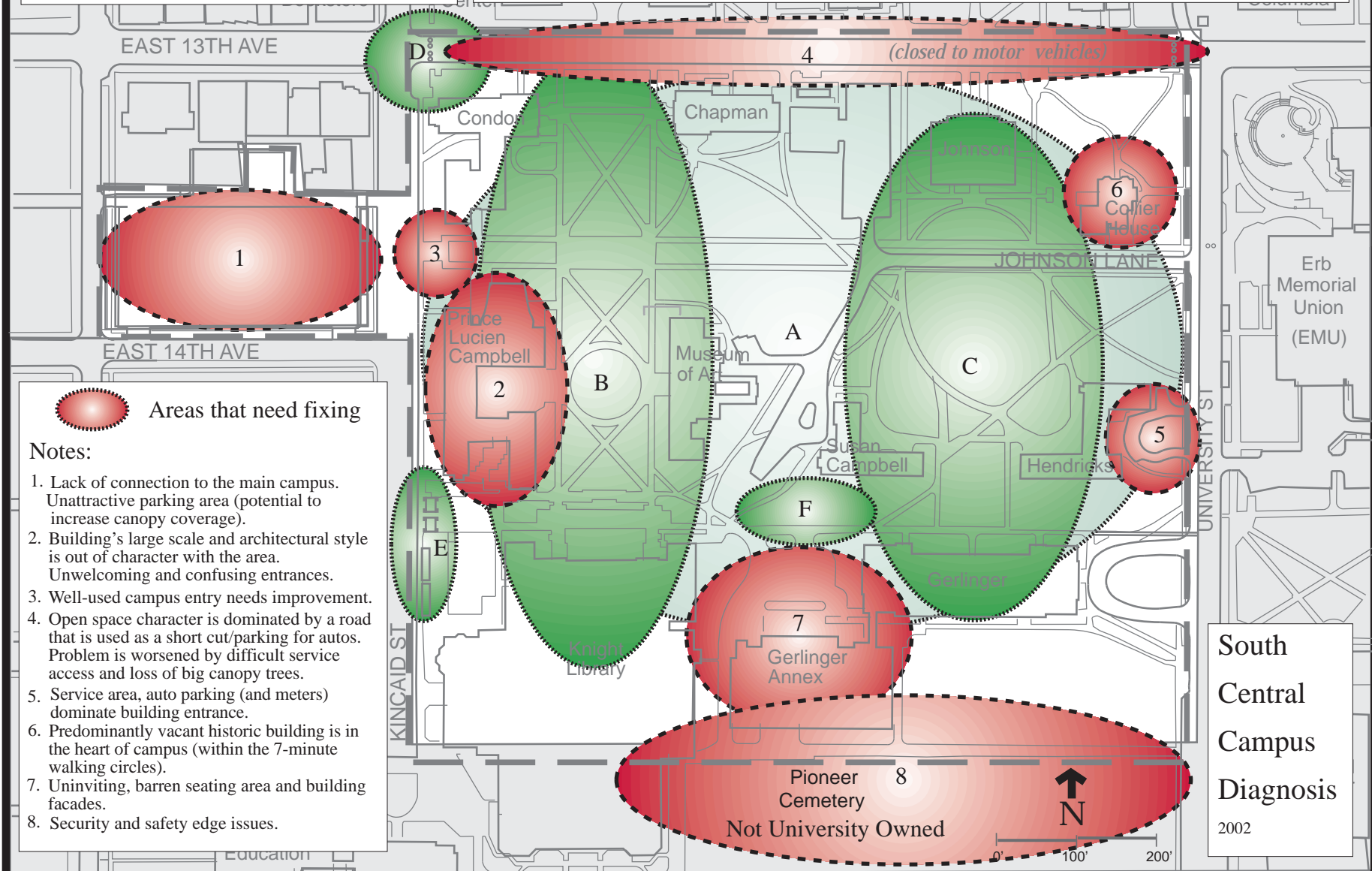

South
Central
Campus
Diagnosis
2002